

MAX FLOW  
MAX PRESSURE  
RATED PUMP SPEED  
POWER REQUIREMENT  
LUBRICATION

8.5 GPM 32 L/MIN  
3000 PSI / 200 BAR  
1750 RPM  
16.5 HP ELECTRIC  
35 OZ UDOR LUBE

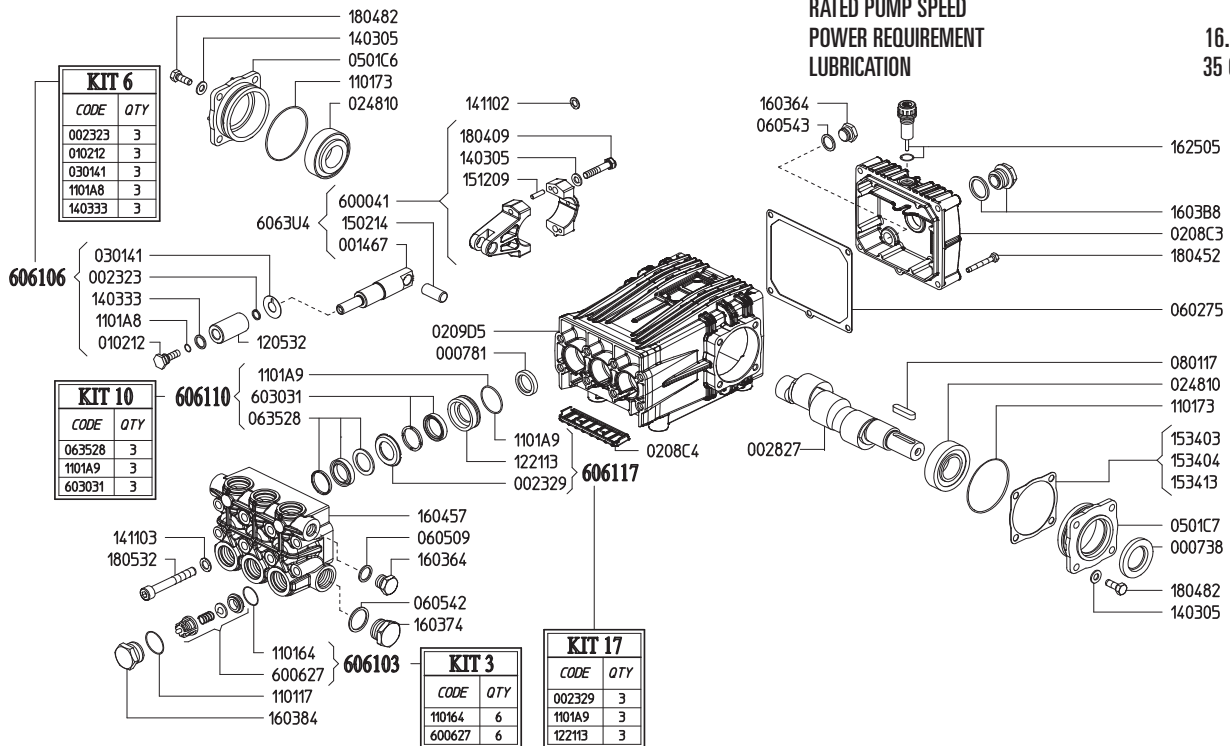

Part #	Description	Qty	Part #	Description	Qty
0007.38	OIL SEAL D30	1	1403.33	WASHER D13.4 <sup>B</sup>	3
0007.81	OIL SEAL D20	3	1411.02	SCHNORR WASHER D8	6
0014.67	PLUNGER GUIDE D22/25/28 "C/CK"	3	1411.03	SCHNORR WASHES D10	8
0023.23	RING D10.4 <sup>B</sup>	3	1502.14	PIN D14X32	3
0023.29	UPPER RING D20 "M/MK" <sup>D</sup>	3	1512.09	PLUG D5X20 UNI1707	6
0028.27	MALE SHAFT D24	1	1534.03	SHIM 0.1 MM	1
0102.12	PLUNGER BOLT <sup>B</sup>	3	1534.04	SHIM 0.2 MM	1
0208.C3	BACK COVER "C/CK"	1	1534.13	SHIM 0.05 MM	1
0208.C4	COVER "C/CK"	1	1603.64	PLUG G3/8	2
0209.D5	CRANKCASE "C/CK/CH"	1	1603.74	PLUG G3/4	1
0248.10	ROLLER BEARING D30	2	1603.84	VALVE PLUG PISTON D22/25	6
0301.41	DISC <sup>B</sup>	3	1603.B8	OIL PLUG G3/4" + GASKET	1
0501.C6	BEARING CLOSED FLANGE	1	1604.57	HEAD "C/G" PISTON D22/25	1
0501.C7	BEARING HOLLOW FLANGE	1	1625.05	OIL PLUG G3/8	1
0602.75	BACK COVER GASKET	1	1804.09	HEX SCREW M8X40 UNI5737	6
0605.09	GASKET D17	1	1804.52	HEX SCREW M6X45 UNI5737	5
0605.42	GASKET D27	1	1804.82	HEX SCREW M8X22 UNI5739	8
0605.43	GASKET D17	1	1805.32	ALLEN SCREW M10X75 UNI5931	8
0635.28	HIGH PRESS SEAL KIT D22 <sup>C</sup>	3	6000.41	ROD ASSEMBLY	3
0801.17	KEY A8X7X35 UNI6604	1	6006.27	VALVE ASSY W/O O-RING <sup>A</sup>	6
1101.17	O-RING D22.23 (RIF.130)	6	6030.31	LOW PRESSURE SEAL KIT D22 <sup>C</sup>	3
1101.64	O-RING D20.24 (RIF 3081) 90SHORE <sup>A</sup>	6	6061.03	KIT 3 VALVE KIT	
1101.73	O-RING D67.95 (RIF.3268)	2	6061.06	KIT 6 PLUNGER KIT	
1101.A8	O-RING D9.25 (RIF.2037) <sup>B</sup>	3	6061.10	KIT 10 WATER SEAL KIT D22 "C/CK"	
1101.A9	O-RING D37.77 (RIF.3150) <sup>C D</sup>	3	6061.17	KIT 17 BRASS RING KIT D22 "C/CK/NX"	
1205.32	CERAMIC PLUNGER D22	3			
1221.13	PRESSURE RING D22 <sup>D</sup>	3			
1403.05	WASHER D8.4	14			

<sup>A</sup> Parts in 6061.03 (Kit 3).

<sup>B</sup> Parts in 6061.06 (Kit 6).

<sup>C</sup> Parts in 6061.10 (Kit 10).

<sup>D</sup> Parts in 6061.17 (Kit 17).