



MANUFACTURER'S HOW TO ASSEMBLE INSTRUCTIONS:
DIRTDAWG-TM11
TWO MAN POST HOLE DIGGER – GAS POWERED

*FOR WARRANTY REGISTRATION CALL: 1-800-245-4777
RICEHYDRO.COM*



ASSEMBLY INSTRUCTIONS

(1) LEFT HAND MARKED "OPERATOR" HANDLE



(1) MARKED "ASSISTANT" KILL SWITCH ASSISTANTS HANDLE



(1) MARKED "LEAN ON THESE HANDLES"



(1) RIGHT HAND THROTTLE HANDLE



(1) TRANSMISSION HONDA ENGINE



RECOMMENDED TOOLS:

1/2" WRENCH 

1/2" SOCKET RACHET 

SCREWDRIVER 

CONNECTING HANDLES

PLACE TRANSMISSION HONDA ENGINE ON A SECURE TABLE FOR ASSEMBLY. CONNECT TWO HANDLES ON ONE SIDE THEN CONNECT THE OTHER TWO ON OPPOSITE SIDES TO BALANCE.

Step 1. CONNECT RIGHT HAND THROTTLE HANDLE WITH LABELED THROTTLE SIDE OF TRANSMISSION

Connect OPERATOR RIGHT HAND THROTTLE into TRANSMISSION HONDA ENGINE where it says THROTTLE SIDE. Place anti-vibration vinyl tubing between handles connection and transmission. Use Wrench to secure tightly in place with bolts, nuts & washers provided. *Note, right hand throttle handle is the only one that the handle can twist.

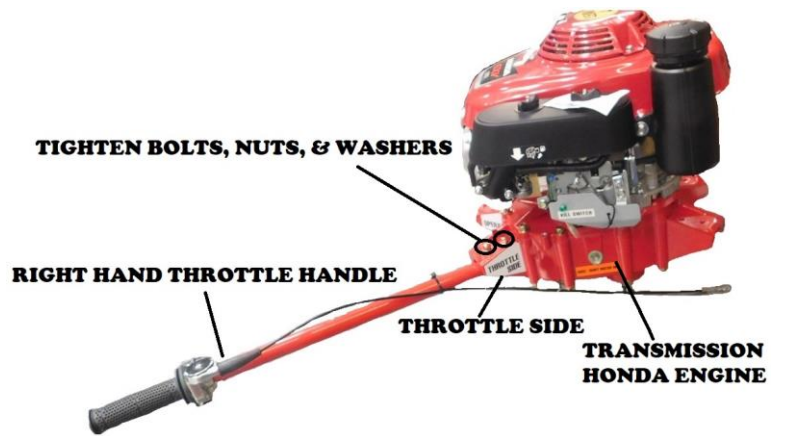

Step 2. CONNECT LEFT HAND HANDLE LABELED "OPERATOR" TO SIDE LABELED OPERATOR ON TRANSMISSION

Connect the handle marked "OPERATOR" into TRANSMISSION HONDA ENGINE where it says OPERATOR in a position directly to the left of the marked throttle handle. Place anti-vibration vinyl tubing between handles connection and transmission. Use Wrench to secure tightly in place with bolts, nuts & washers provided.

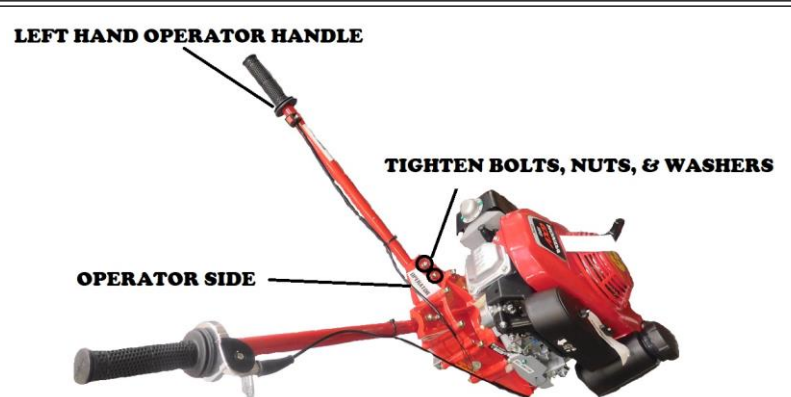

Step 3. CONNECT LEFT SIDE HANDLE LABELED "ASSISTANT" TO SIDE LABELED ASSISTANT ON TRANSMISSION

Move around to the "ASSISTANT" side of your TRANSMISSION HONDA ENGINE and securely connect the assistant left side handle. Place anti-vibration vinyl tubing between handles connection and transmission. Use Wrench to secure tightly in place with bolts, nuts & washers provided



Step 4. CONNECT RIGHT HAND LEAN ON THIS HANDLE TO UNLABELED SIDE ON TRANSMISSION

Connect the handle marked "LEAN ON THIS HANDLE". Place anti-vibration vinyl tubing between handles connection and transmission. Use Wrench to secure tightly in place with bolts, nuts & washers provided.



CONNECTING CABLE WIRES

Step 1. CONNECT RIGHT HAND THROTTLE HANDLE CABLE WIRE

As shown in picture, connect the throttle cable thru clamp, securing clamp at the one o'clock positions then secure the cable eyelet & tighten screw. *To prevent binding of the throttle cable, maintain loop as shown in picture.

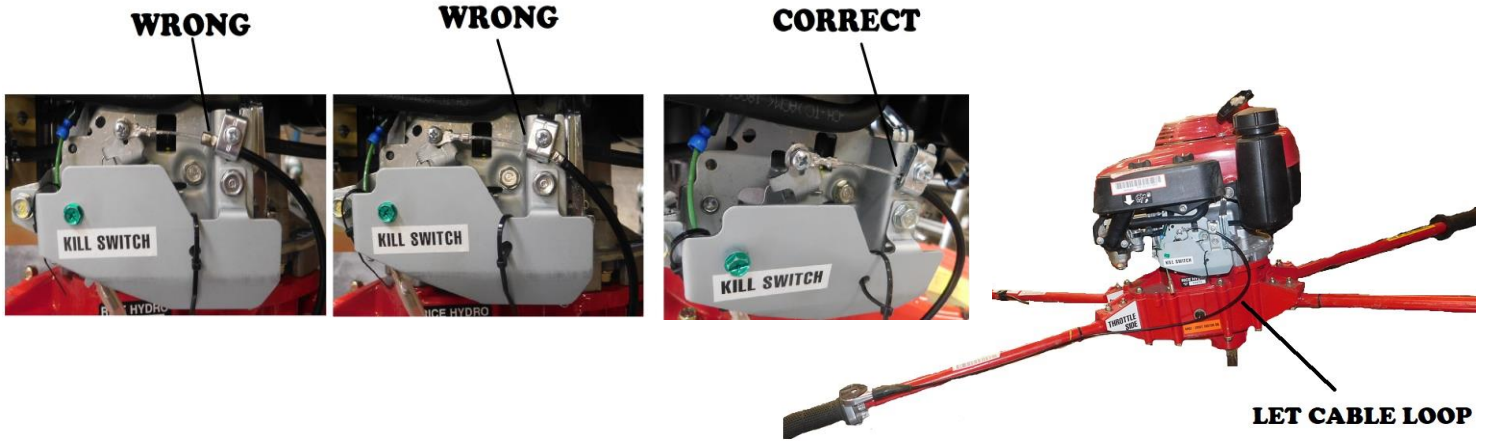

Step 2. CONNECT LEFT HAND OPERATOR THROTTLE CABLE WIRE

You are now ready to connect the “RING” & “BULLET” WIRES from the OPERATOR HANDLE. Remove the GROUND SCREW (GREEN IN COLOR) on top of the KILL SWITCH sticker. Place OPERATOR “RING WIRE” over ground screw, and center. Next, connect the “BULLET WIRE” from the OPERATOR. Slide bullet into plastic sleeve on receiver wires. *Side or color of wires or receivers are not specific.

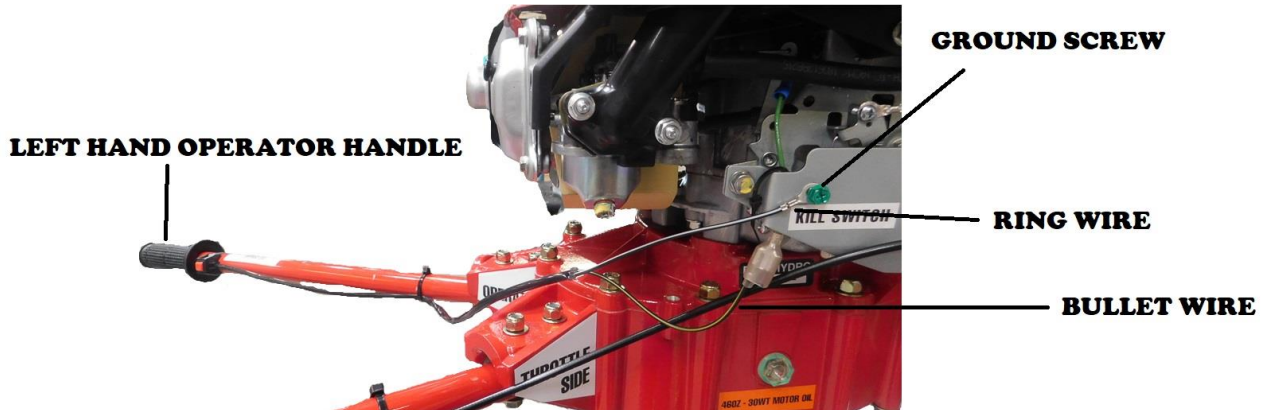

Step 3. CONNECT ASSISTANT THROTTLE CABLE WIRE

You are now ready to connect the “RING” & “BULLET” WIRES for the ASSISTANT HANDLE. Remove the GROUND SCREW (GREEN IN COLOR) on top of the KILL SWITCH sticker. Place ASSISTANT “RING WIRE” over OPERATOR “RING WIRE” & use GROUND SCREW to tighten, and center. Next, connect the “BULLET WIRE” from the OPERATOR. Slide bullet into plastic sleeve on receiver wires. Use zip ties & snugly secure wires.

