

# GD 8.0/22-S

Revised 10-1-2005

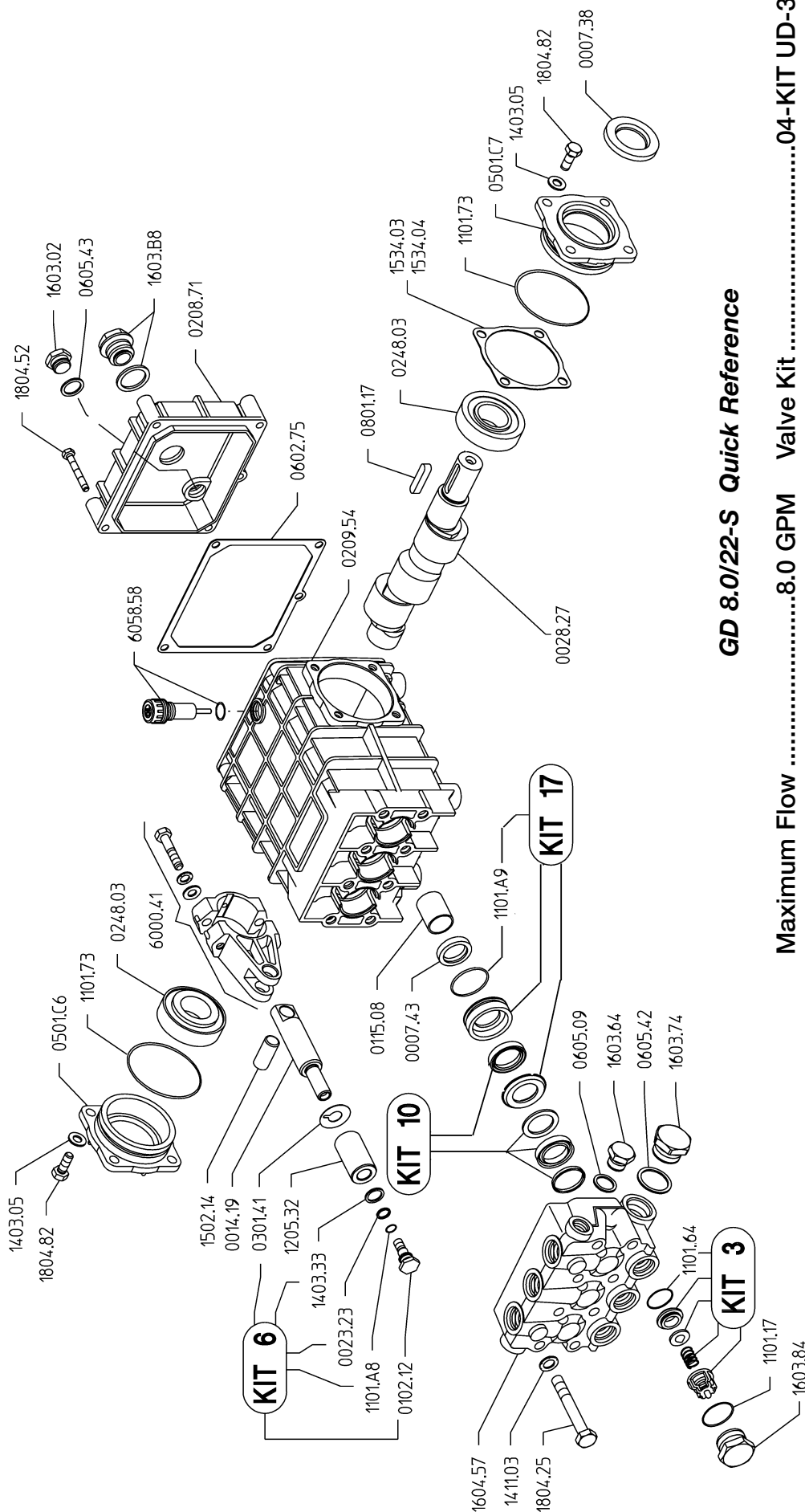
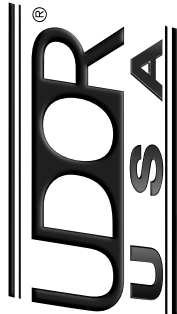

## GD 8.0/22-S Quick Reference

|                        |                                                     |                        |              |
|------------------------|-----------------------------------------------------|------------------------|--------------|
| Maximum Flow .....     | 8.0 GPM                                             | Valve Kit .....        | 04-KIT UD-3  |
| Maximum Pressure ..... | 2200 PSI                                            | Seal Kit .....         | 04-KIT UD-10 |
| Rated Pump Speed ..... | 1750 RPM                                            | Brass Kit .....        | 04-KIT UD-17 |
| Oil Capacity .....     | 40 oz. UDOR LUBE<br>or SAE 30W<br>Non-Detergent Oil | Plunger Bolt Kit ..... | 04-KIT UD-6  |
|                        |                                                     | Plunger Part # .....   | 04-1205.32   |
|                        |                                                     | Plunger Diameter ..... | 22 MM        |

**GD 8.0/22-S**

PARTS BREAKDOWN FOR MODEL EL-8/12  
RICE HYDRO, INC.

| PART NUMBER.. | DESCRIPTION..        | QTY<br>REQ'D |
|---------------|----------------------|--------------|
| UD04-0007.38  | SEAL                 | 1            |
| UD04-0007.43  | SEAL                 | 3            |
| UD04-0014.19  | PLUNGER ROD          | 3            |
| UD04-0023.23  | SUPPORT RING         | 3            |
| UD04-0028.27  | CRANKSHAFT           | 1            |
| UD04-0102.12  | PLUNGER BOLT         | 3            |
| UD04-0115.08  | ROD GUIDE            | 3            |
| UD04-0208.71  | BACK COVER           | 1            |
| UD04-0209.54  | CRANKCASE            | 1            |
| UD04-0248.03  | BEARING              | 2            |
| UD04-0301.41  | SLINGER RING         | 3            |
| UD04-0501.C6  | BEARING CAP          | 1            |
| UD04-0501.C7  | BEARING CAP          | 1            |
| UD04-0602.75  | GASKET               | 1            |
| UD02-0605.09  | GASKET               | 1            |
| UD04-0605.42  | WASHER               | 1            |
| UD02-0605.43  | GASKET               | 1            |
| UD04-0801.17  | KEY                  | 1            |
| UD04-1101.17  | O-RING               | 6            |
| UD04-1101.A9  | RETAINER O-RING      | 6            |
| UD02-1101.A8  | O-RING               | 6            |
| UD04-1101.64  | O-RING               | 6            |
| UD04-1101.73  | O-RING               | 2            |
| UD04-1205.32  | PLUNGER - 22 MM      | 3            |
| UD04-1403.05  | WASHER               | 8            |
| UD04-1403.33  | ONLY AVAIL IN KIT #6 | 3            |
| UD02-1411.03  | WASHER               | 8            |
| UD04-1502.14  | CONNECTING ROD PIN   | 3            |
| UD04-1534.03  | SHIM .003            | 1            |
| UD04-1534.04  | SHIM .010            | 1            |
| UD04-1603.64  | DISCHARGE PLUG       | 1            |
| UD04-1603.74  | INLET PLUG           | 1            |
| UD04-1603.B8  | SIGHT GLASS          | 1            |
| UD04-1603.02  | DRAIN PLUG           | 1            |
| UD04-1603.84  | VALVE CAP            | 6            |
| UD04-1604.57  | MANIFOLD 22MM        | 1            |
| UD02-1804.25  | BOLT                 | 8            |
| UD02-1804.52  | BOLT                 | 4            |
| UD04-1804.82  | BOLT                 | 8            |
| UD04-6000.41  | CONNECTING ROD       | 3            |
| UD04-6058.58  | DIP STICK            | 1            |

MISCELLANOUS PARTS..

|                     |                                      |   |
|---------------------|--------------------------------------|---|
| MOTOR-7.5HP-3PH     | 7.5HP 60HZ 3 PHASE C-FACE MOTOR      | 1 |
| PUMP-8.0/22-S       | PLUNGER PUMP                         | 1 |
| UNLOADER-1500PSI    | 500-1500PSI UNLOADER - YELLOW SPRING | 1 |
| HOSESWIVEL-1/2      | HOSE SWIVEL INLET                    | 1 |
| GAUGE-1500          | 0-1500 PSI LIQUID FILLED GAUGE       | 1 |
| LINESTRAINER-1/2    | MXM 100 MESH                         | 1 |
| NEEDLEVALVE-1/4     | AIR BLEED VALVE                      | 1 |
| BALLVALVE-3/8HP     | 3/8" HIGH PRESSURE BALLVALVE         | 1 |
| HOSE-3/8X8-RH       | 8' FOOT OUTLET HOSE - STANDARD       | 1 |
| COUPLERPLUG-3/8M    | MALE PUMP OUTLET - PIPING            | 1 |
| COUPLERBODY-BR-3/8F | FEMALE PUMP OUTLET - HOSE            | 1 |
| LABEL-KIT-EL        | CAUTION AND INSTRUCTION STICKERS     | 1 |

KITS..

|               |                  |   |
|---------------|------------------|---|
| UD04-KIT-UD3  | VALVE KIT        | 1 |
| UD04-KIT-UD6  | PLUNGER BOLT KIT | 1 |
| UD04-KIT-UD10 | SEAL KIT         | 1 |
| UD04-KIT-UD17 | BRASS KIT        | 1 |